

ROSIN SMYTH



21-31 Reynolds Street North Melbourne VIC

2 

- CLEAR SPAN DESIGN
- TOTAL AREA 423 M2* APPROX
- ROLLER DOOR ACCESS FROM FRONT
- SEPARATE OFFICE AREA
- FULLY AIR CONDITIONED
- WIDE FRONTAGE 24.75 M
- SIDE CARPARK AREA
- SPECIAL USE ZONE
- EXCELLENT AMENITIES
- ADJACENT TO THE ARDEN URBAN RENEWAL PROJECT

Type : Industrial
Building Size : 423 sqm
Land Size : 423 sqm
View : <https://www.rosinsmyth.com.au/8082258>

For any additional information please contact Martin Smyth
| 0411 744 000



Martin Smyth
9695 5999

[For full version visit the website](https://www.rosinsmyth.com.au)

<https://www.rosinsmyth.com.au>

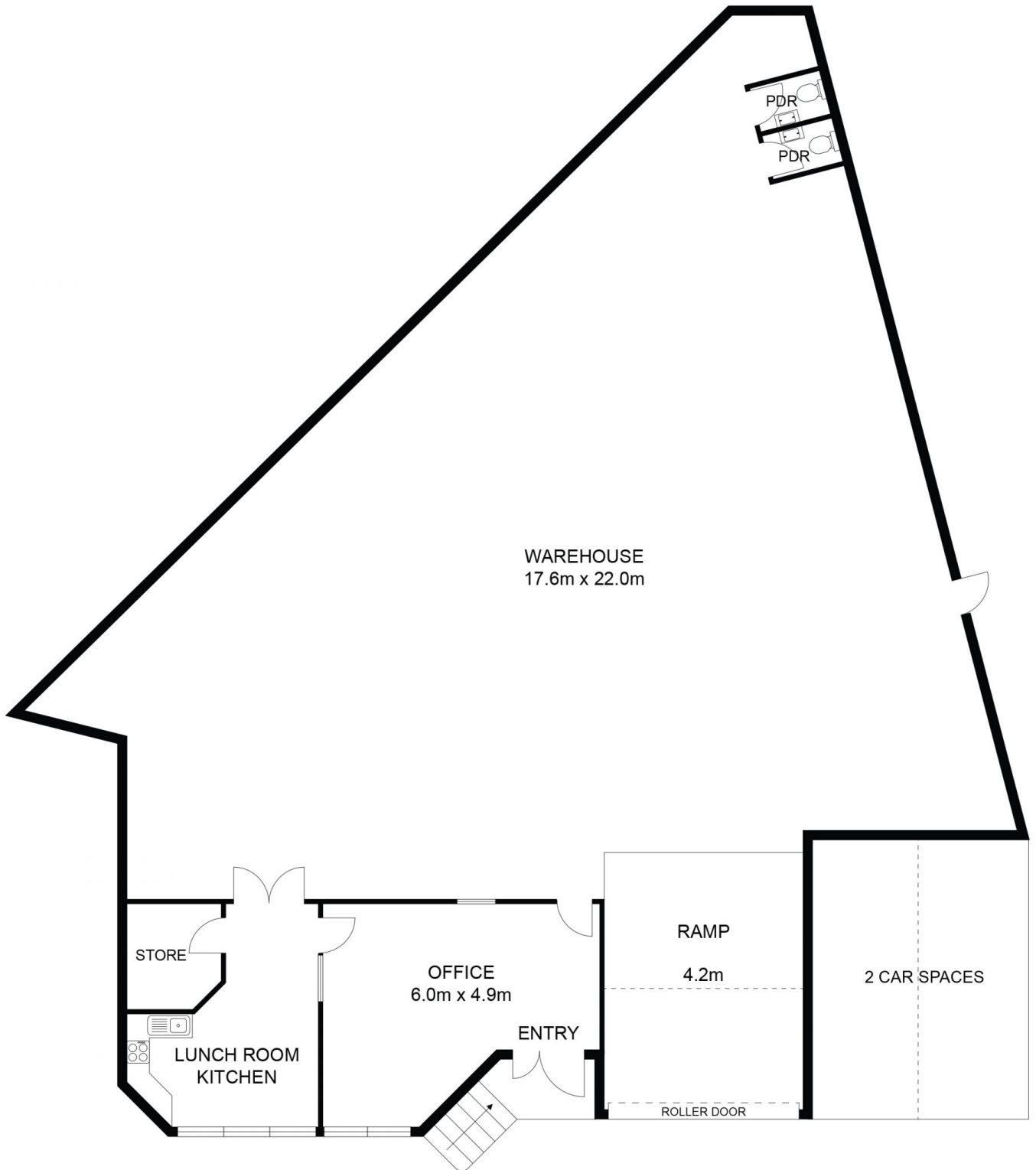

21-31 Reynolds Street, North Melbourne



DISCLAIMER : ALL DIMENSIONS ARE AN APPROXIMATION ONLY AND NO GUARANTEE IS GIVEN WITH RESPECT TO ACCURACY.